

Connection hoses and cables	
Water hose:	✓
Waste water hose:	✗
Electric cable:	✓

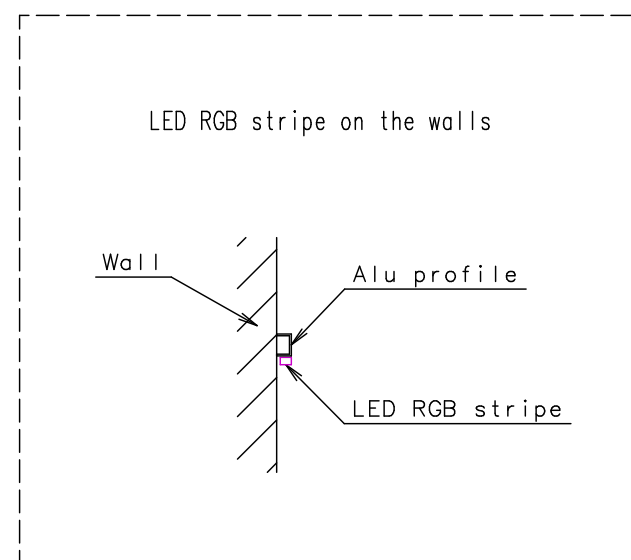
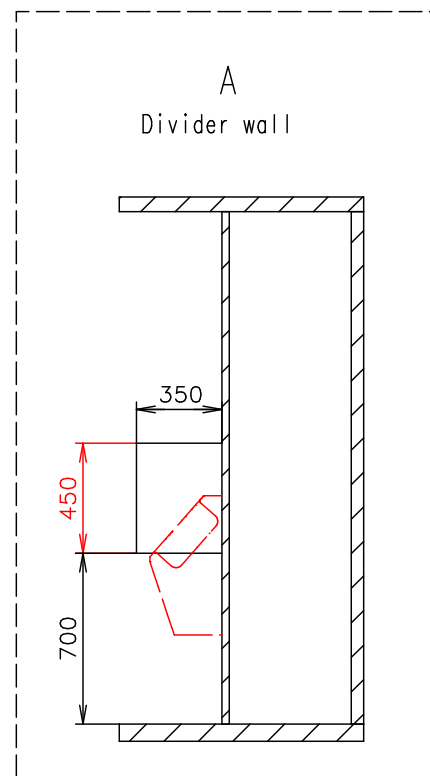
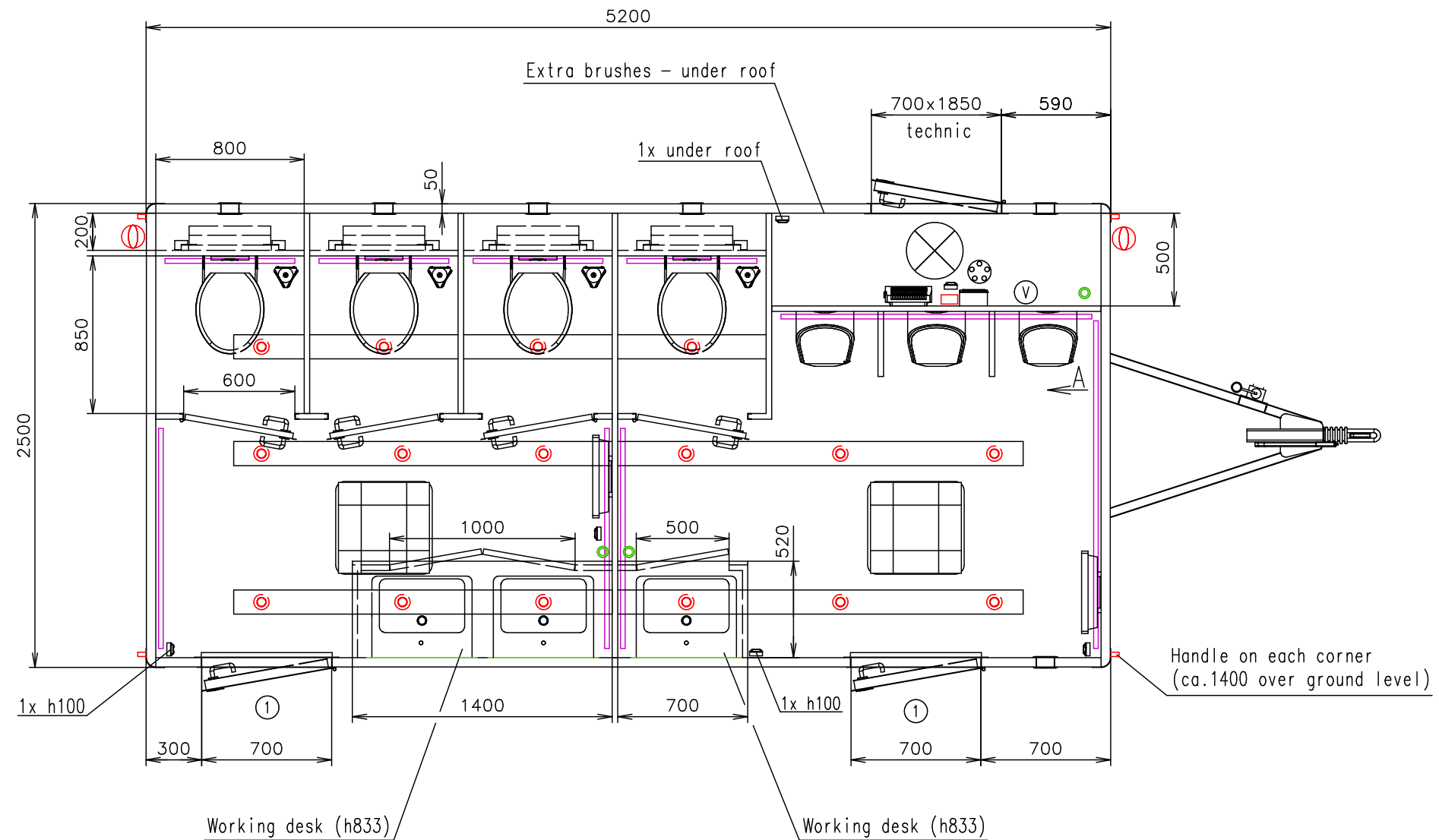

Working desks in waterproof compact desk Egger (dark color)

Wall between wash-basin and mirror - decor like working desk

Notes: Without paper holders Folio - black ?

Interior height:	2100 mm	Total weight:	2000 kg
Color:	RAL 9010 + folio	Tare weight-estimate:	1700 kg
Floor:	Gray fiberglass	Centre of wheels from rear side:	2540 mm
Date:	20.4.2017	Wheels:	155 R13

**EUROWAGON**

Drawing number:  
2612-52-2\_1/2 (Maas)

(Cabling and piping is not shown on the 3D views and drawings)

Connection hoses and cables	
Water hose:	✓
Waste water hose:	✗
Electric cable:	✓

- Ⓥ Water connection 3/4" (through the floor) + filter
- Ⓢ Electric connection (through the floor) (230V-16A)
- Ⓣ Effluent connection (through wall) - connection point A110
- Ⓜ Power point
- Ⓛ Switch board (1200 over floor)
- ⓧ Sensorlight
- Ⓞ Spot light - dimmable
- Ⓛ Dimmer - for spot lights
- LED RGB stripe - indirect light (sketch) - 1200 over floor - switch in technical room
- Ⓜ Heating (500W)
- Ⓜ Heating (750W)
- Ⓞ Floor drain hole
- Ⓜ Wash-basin (over the desk) Keramag (550x440) - without water tap - only preparing (cold water)
- Ⓜ Hanging toilet - without toilet seat
- Ⓜ Urinal - Vitra Siko (water flush)
- Ⓜ Roof window Dometic (400x400)
- Ⓜ Ventilation ø120
- Ⓜ Brush toilet
- Mirror (600x600)
- ① Foldable stairs Serena + 1x handrail

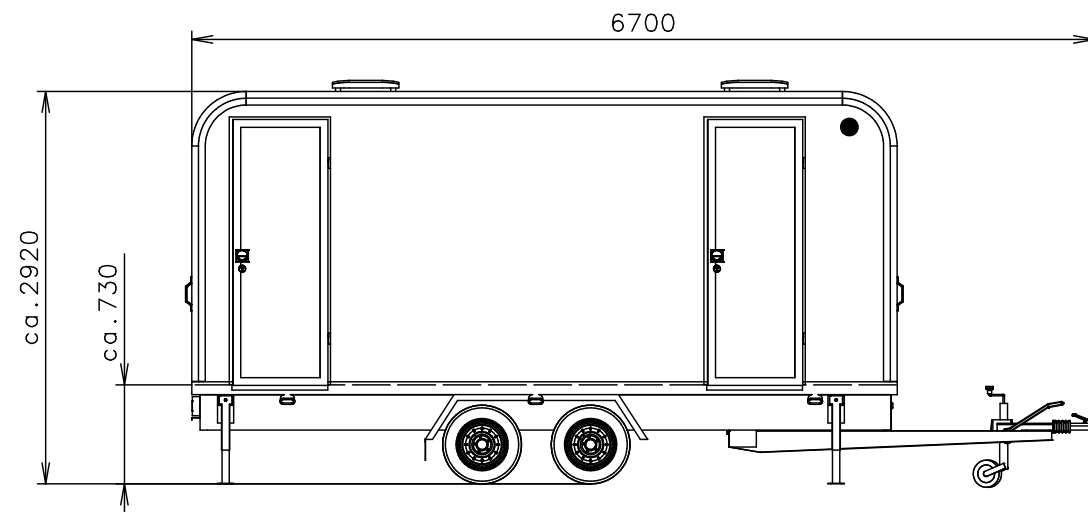

(Cabling and piping is not shown on the 3D views and drawings)

Working desks in waterproof compact desk Egger (dark color)

Wall between wash-basin and mirror - decor like working desk

Notes: Without paper holders Folio - black ?

Interior height:	2100 mm	Total weight:	2000 kg
Color:	RAL 9010 + folio	Tare weight-estimate:	1700 kg
Floor:	Gray fiberglass	Centre of wheels from rear side:	2540 mm
Date:	20.4.2017	Wheels:	155 R13

**EUROWAGON**

Drawing number:  
2612-52-2\_2/2 (Maas)